

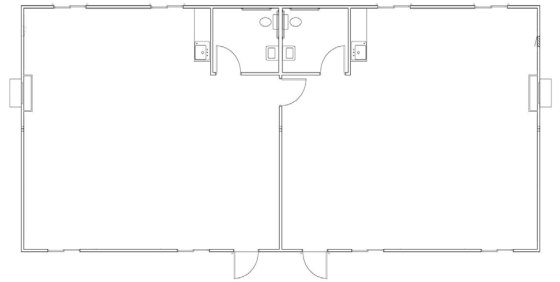

WALKER MIDDLE SCHOOL

Salem, OR

Salem-Keizer School District (SKSD) was in need of four classrooms for Walker Middle School in West Salem, OR and had originally planned to have Modern provide two double classroom portables per the SKSD standard specifications. Upon Modern's review of the site and the setback restrictions with the district it was determined that a four classroom complex would be the best approach in order to fit on the site without having to install sprinkler systems. In order to complement the existing structures the building was installed on a permanent concrete stem wall foundation, cement fiber lap siding was installed along with 24 gauge standing seam roofing. The roof and entry porches were site installed to increase the roof pitch and give the building a permanent look and feel. The interior finishes included: solid surface flooring and walls, custom classroom casework, and various sized whiteboards and tack boards.



PROJECT HIGHLIGHTS

- The building has dimensions of 28'x64'.
- The building area was 1792 square feet.
- The foundation is Block and Level.



WE OFFER QUALITY
FACTORY-DIRECT BUILDINGS
AT A PREDICTABLE COST