

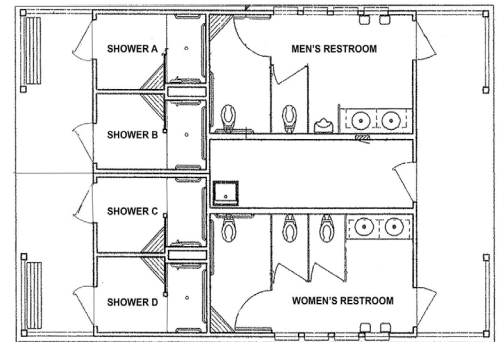

FORT STEVENS STATE PARK

Fort Stevens, OR

Located on the northern Oregon Coast, Fort Stevens is a public restroom/shower facility constructed for the State of Oregon Parks and Recreation Department. Modular units were shipped complete with cement floors and all fixtures previously installed. Site utilities were installed while the building was being constructed at the manufacturing plant to minimize the time and impact at the site. Minimum power consumption was facilitated by installing occupancy sensors and sensor controls for lighting and fans. High efficiency gas boilers for water heaters were used combined with a re-circulation system and expansion tanks. Vandal-proof fixtures were installed throughout the building to help increase longevity.



PROJECT HIGHLIGHTS

- The building has dimensions of 25'x39'.
- The building area was 975 square feet.
- The foundation is Stem Wall.



WE OFFER QUALITY
FACTORY-DIRECT BUILDINGS
AT A PREDICTABLE COST