

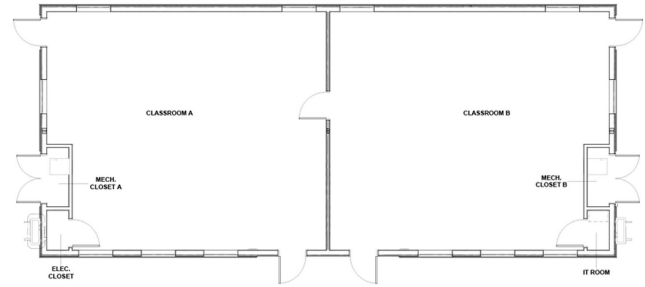

CAMAS PRAIRIE ELEMENTARY SCHOOL

Spanaway, WA

Bethel School District has experienced a tremendous amount of growth in recent years. As the district reviewed long range forecasting, they identified the need for additional space. Modular construction offered the flexibility to add more buildings as needed. Modern constructed two 28' x 66' modular office buildings that were joined by a common breezeway, leading to the main administrative offices. The buildings were constructed off-site and installed quickly over the winter break to minimize disruption of the district offices. At the end of the school year, a second portable was installed with covered walkways to match the previous structures. Mitsubishi heat systems were installed in the buildings, allowing each office occupant to meet their own comfort needs. Solid core doors and wood window surrounds, along with a tape and texture finish, provides a warm, professional office environment.



PROJECT HIGHLIGHTS

- The building has dimensions of 28'x62'.
- The building area was 1792 square feet.
- The foundation is Post & Beam.



WE OFFER QUALITY
FACTORY-DIRECT BUILDINGS
AT A PREDICTABLE COST