



MODERN BUILDING SYSTEMS, INC

"The Environmentally Smart Choice..."

Project Summary

Newberg Family Dentistry

www.mbs-modular.com



Newberg Family Dentistry is located in Newberg, Oregon. This custom 2,600 sf clinic was built in 1996 and contains many aesthetically pleasing aspects. For instance, an 8/12 roof pitch, lap siding, barrel ceilings in the waiting room and hallway, arched pass-thru to a curved reception counter, ceramic tile entry and accent lighting to showcase all of this building's unique features.

The owner adopted and incorporated exterior features of the surrounding structures into this functional and attractive office.

To accommodate the doctor's needs, several exam and procedure rooms are situated in the back of the building, leaving the front portion of the building open for a private consultation room, file storage and a bright, comfortable waiting area.

Tucked away in the spacious attic of this clinic, sits a multi-zone heating system to control the atmosphere of the busy office below. Placing the unit in this space allowed for more interior to be utilized for day-to-day operations and in turn cuts down on the noise that would normally be heard from a forced air heating/cooling system.

This turnkey project is just one of the many buildings that **Modern Building Systems** has custom tailored to the owner's needs and desires.

When searching the industry for a full service company that can fulfill your company's space needs, **Modern Building Systems** is *"The Environmentally Smart Choice..."*.

Features:

- Highly energy efficient
- Custom designed utility wall in each exam room allows for flexibility and upgrades
- Specialized domed ceilings with soffit lighting
- Custom built casework and reception desk
- Complete turnkey service
- Controlled construction conditions minimized weather delays and keeps cost down

**P.O. Box 110 9493 Porter Road
Aumsville, OR 97325 USA**

tel: 503.749.4949

fax: 503.749.4950

**1550 Thornton Avenue SW
Pacific, WA 98047 USA**

tel: 253.863.8863

fax: 253.863.8867

**605 Sutter Street
West Sacramento, CA 95691 USA**

tel: 916.985.9852

fax: 916.985.9865

Newberg Family Dentistry Dental Offices

1. Exam Rooms
2. Offices
3. Reception
4. Employee Break Room
5. Waiting Room
6. Consulting
7. Work Area
8. Sterilization
9. Restroom

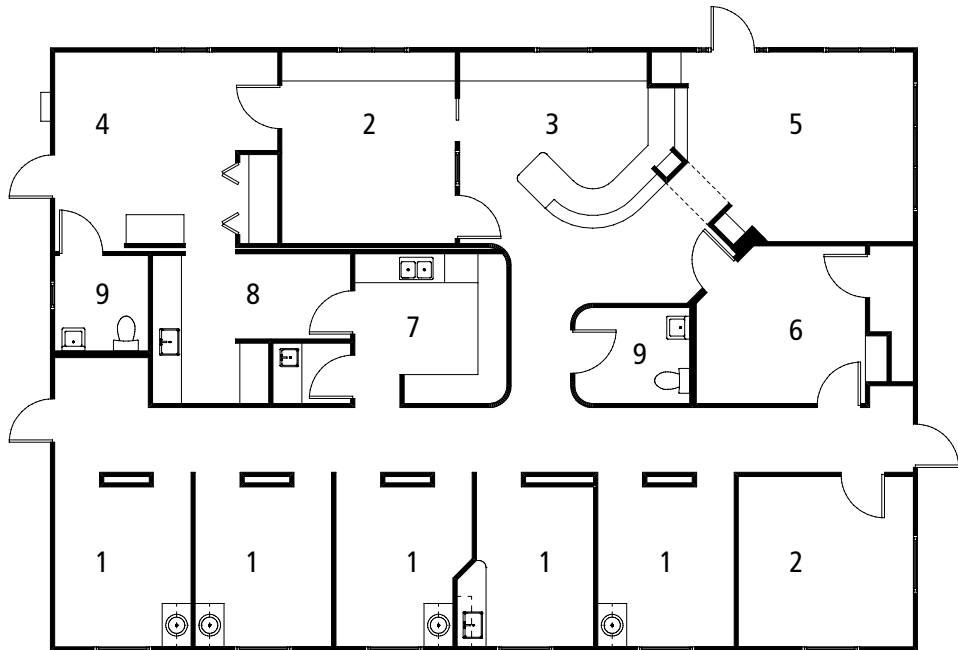

Modern Building Systems, Inc. Mobile and Modular Offices: Tomorrow's Solutions Today

When you consider the time, cost and flexibility your new building will involve consider **Modern Building Systems**.

We offer speed and efficiency for expansion or relocation and can build to compliment existing structures. Our economical, attractive, and functional commercial space is built with environmentally responsible turnkey construction.

Complete services include design and engineering offering potential savings in construction costs over site-built buildings. Your complete facility will be built on our premises and is ready for immediate occupancy on your land within days. If you need, the entire modular building can be relocated to another site in the future.

Our personal service and professional staff will work with you to meet all your building needs. For an accurate advance estimate of the budget and time requirements of a modular solution, call today for more information.

"Without Modern Building Systems' outstanding management and competent, professional staff, it would not have been possible to consistently meet our tight budgets and limited schedule."

Reg Martinson, Director of Facilities
Evergreen School District

Modern Building Systems, Inc.

800.682.1422

Visit us at:
www.mbs-modular.com

Oregon

**P.O. Box 110 9493 Porter Road
Aumsville, OR 97325 USA**

tel: 503.749.4949

fax: 503.749.4950

Washington

**1550 Thornton Avenue SW
Pacific, WA 98047 USA**

tel: 253.863.8863

fax: 253.863.8867

California

**605 Sutter Street
West Sacramento, CA 95691 USA**

tel: 916.985.9852

fax: 912.985.9865