



MODERN BUILDING SYSTEMS, INC.
"The Environmentally Smart Choice..."

MOLECULAR PROBES

PROJECT SUMMARY



Located in the west side of Eugene, Oregon, Molecular Probes was a 26,000-square-foot project built in 1992. This project features two-story construction with a complete, 2 uninterruptible power supply system and an elevator.

A 50-foot skybridge was constructed to allow access to the second-story offices from visitor parking situated on higher ground than the first floor. Lap siding and offices with a view are only a few of the visible advantages to this office.

Choosing modular construction allowed Molecular Probes the option of leaving space in their design plans for future expansion. Interior finishes are drop-grid ceilings, carpeted and vinyl floor coverings. Other visible advantages and features include interior finishes of taped, textured and painted sheet rock, reception area, private office space, meeting and lunch room, lab areas, refrigeration units for specimens and a sprinkler system for fire protection.

Modular construction was chosen by the fast-growing, sophisticated bio-med technical company because of the speed that Modern Building Systems could deliver a completed project. Larger amounts of rain that spring impacted site scheduling, but did not slow the projected opening date for the company's new headquarters.

The modular building's complete turnaround time from planning to completion was seven months.

We are *"The Environmentally Smart Choice..."* for all your building needs. Contact us today to learn more.

FEATURES:

- Complete site development including excavation, utilities and parking lot
- 50-foot skybridge to access second floor
- Advanced complete building uninterruptible power supply system
- Simultaneous site development and building construction
- Complete turnkey project





MOLECULAR PROBES

MODERN BUILDING SYSTEMS, INC.

"The Environmentally Smart Choice..."

Molecular Probes

- 1 Offices
- 2 Reception Area
- 3 Lunch & Training Room
- 4 Conference Room
- 5 Lobby
- 6 Elevator
- 7 Customer Service
- 8 Restroom
- 9 Other

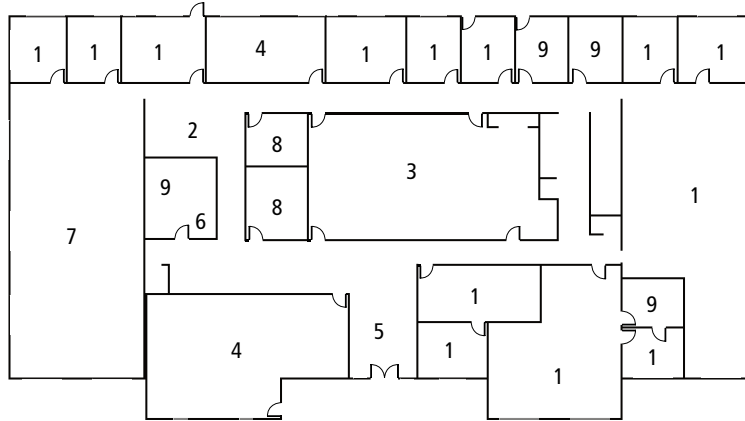

QUALITY IS OUR FUTURE. AND YOURS.

What makes Modern special? Simply put, **it's our team.**

Our people are the difference. They produce a quality product that's simply unmatched in the modular industry. Since December 6, 1971, our team has been passionate about what we build and how we put it all together. Our strength, experience and commitment to quality is why we'll be around for a long time to come, making sure our customers enjoy the best quality products at the most competitive prices.

We're the oldest commercial modular building company on the West Coast. Modern is 130 team members strong – and we're growing. We're a family owned and operated business, started by Don Rasmussen and carried on by his sons, Jim and Ken Rasmussen.

Our company is a design-and-build manufacturer, constructing everything from offices, medical building and classrooms – essentially anything but residential. **We've worked for government agencies across the country, built a blast-proof flight simulator for Boeing and constructed a four-story building at the Red Dog Mine near the Arctic Circle.**

Our modular construction offers significant savings over traditional, site-built construction. Our structures are factory-built, allowing construction to occur during any season, and installed quickly, saving time and reducing costs. We lease and sell temporary job-site trailers, mobile sales offices, construction-site offices, portable classrooms, complete schools, modular offices, medical clinics, modular daycare facilities, relocatable buildings, restroom/shower trailers and prefabricated buildings. We have our own fleet of delivery trucks, and maintain our own installation crews, equipment and service departments, so we're 100% responsible for our work.

We pride ourselves on being the number one choice for top-quality, environmentally friendly buildings at very competitive prices, with no dealer-reseller mark-ups. Our goal is your satisfaction – and making sure your needs have been met and exceeded. Call us today for more information.

TESTIMONIALS

What our clients have to say:

"Modular buildings are fantastic. As soon as I can I'm going to build another. I can't understand why more people aren't building modular."

*–Jim Aydelott
Symantec Corporation,
Operations Manager
Seattle Daily Journal of Commerce*

CONTACT US TODAY

Oregon

P.O. Box 110 9493 Porter Road
Aumsville, OR 97325 USA
Phone: 503.749.4949
Fax: 503.749.4950

Washington

1550 Thornton Avenue SW
Pacific, WA 98047 USA
Phone: 253.863.8863
Fax: 253.863.8867

California

605 Sutter Street
West Sacramento, CA 95691 USA
Phone: 916.985.9852
Fax: 912.985.9865