

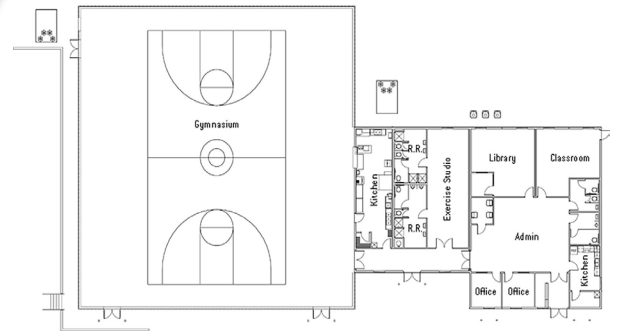

SHINGLE CREEK RECREATIONAL FACILITY

Placerville, CA

The Shingle Springs Band of Miwok Indians partnered with Modern to build an education center that includes classroom space, library, children's play center, physical fitness center, commercial kitchen, and gymnasium. The facility couples a 5,000 square foot modular building and a 10,000 square foot panelized gymnasium with university quality hardwood flooring, multiple goals, and bleachers. This is a great example of the synergy available between different types of "modular" construction, fully integrated as one unit. The building has energy efficient windows, high efficiency water heaters and furnaces, low flow showerheads and occupancy sensors in all rooms.



PROJECT HIGHLIGHTS

- The building has dimensions of 90'x54'.
- The building area was 4860 square feet.
- The foundation is Stem Wall.



WE OFFER QUALITY
FACTORY-DIRECT BUILDINGS
AT A PREDICTABLE COST