

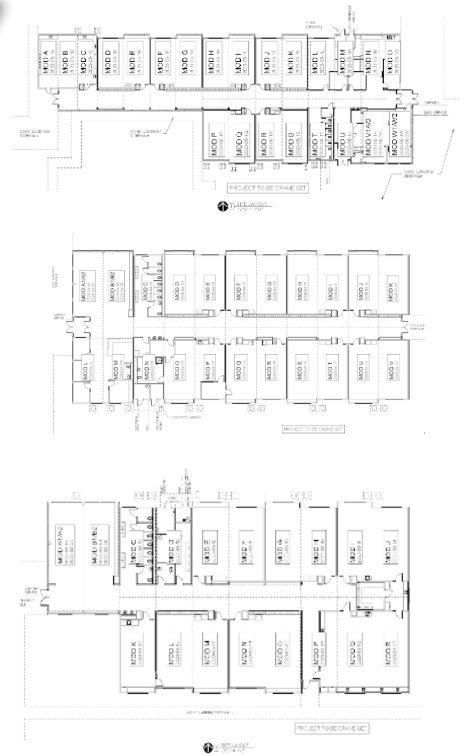

## SANTIAM CANYON SCHOOL DISTRICT JUNIOR AND SENIOR HIGH SCHOOL Mill City, OR

The new Santiam Canyon Junior and Senior High School is a 41,530 square foot facility designed to serve the needs of over three hundred 7th -12th graders, its teachers, and its school staff. The campus is comprised of three large buildings that house sixteen regular classrooms, a nurse training space, a science lab, a culinary training kitchen, a flex space, a multimedia room, a library, several counsel rooms, and administrative offices. The design of the buildings honors the natural beauty of the surrounding mountains as well as the town's logging heritage.

In addition to the needs of the school, the project was on a tight bond budget. Modular construction offered a cost-effective means to build quickly, sustainably, and with minimal disturbance to the existing campus, which needed to be torn down before new construction began. The completed school incorporates sustainable and energy efficient features to keep ongoing operations at a minimum cost.



### PROJECT HIGHLIGHTS

- Project deadlines were scheduled ten months from the start of construction. Due to wildfires and smoke remediation, the campus was completed four months late. It was completed on 2/1/21.
- The campus buildings are constructed of sixty-nine separate modules, each one measuring sixteen feet wide, sixteen feet high, with varying lengths of forty to forty-eight feet. Higher ceilings were achieved by stacking modules on top of one another. Modern Building Systems designed, manufactured, transported, and craned in all of the modules for the project.
- Gender neutral bathrooms cut the cost of bathroom construction in half.
- A sense of community was important to the final facility. While the campus has three separate buildings, the main entrance funnels through one building, allowing the faculty to personally greet the students each morning.

### SUSTAINABILITY FEATURES

- All drinking fountains have water bottle filling stations to reduce plastic waste.
- Each building supports a "Solar-Ready" design.
- Strict MDP designs and commissioning were conducted to create highly energy-efficient mechanical systems.
- The entire campus uses controlled led lighting to decrease energy consumption.
- All lumber was 100% locally sourced in this project.
- Waste was reduced by up to 90% using exact material amounts, controlling inventory items, and recycled materials.



**WE OFFER QUALITY  
FACTORY-DIRECT  
BUILDINGS**



Santiam Canyon  
*Building I*



Santiam Canyon  
*Building II*



Santiam Canyon  
*Building III*